

	X 4		X 8
	X 4		X 4
	X 4		X 4
	X 1		X 8
	X 1		X 4

	X 4		X 4
	X 4		X 4
			X 2

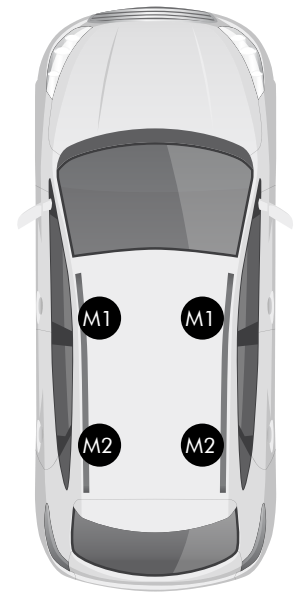

				M1	M2
MERCEDES	C (W204)	4	07>13	11,9	9,7
MERCEDES	C (W205)	4	14>	11,5	6,2
MERCEDES	C Coupé (C205)	3	15>	6,4	6,7
MERCEDES	CLS (C218)	4	04>10	8,1	7,0
MERCEDES	CLS (C219)	4	10>	7,8	5,1
MERCEDES	CLS Shooting Brake (X218)	5	12>14	8,7	5,2
MERCEDES	E (W212)	4	10>16	6,1	2,9
MERCEDES	E (W213)	4	16>	2,4	0,9
MERCEDES	E Coupé (C238)	2	17>	10,3	8,5
MERCEDES	GLC Coupé (C253)	5	15>	4,5	1,2
MERCEDES	R (W251)	5	05>13	5,8	1,3
MERCEDES	S (W222)	4	14>	14,8	11,7
TOYOTA	Avensis III Station Wagon	5	09>	9,7	8,6



Le tabelle di applicabilità sono soggette ad invecchiamento e/o modifiche, in caso di dubbio si consiglia di consultare il sito www.k39.it costantemente aggiornato.
The applicability tables are subject to aging and/or changes, in case of doubt it is advisable to consult the constantly updated website www.k39.it.



			M1	M2	M3	M4	M5
CITROEN	Berlingo (B9)	08>14	7,6	5,1	4,1		
CITROEN	Berlingo (B9)	15>18	7,6	5,1	4,1		
NISSAN	Kubistar	03>	5,4	5,8			
NISSAN	Nv 200	09>	4,6	5,0			4,2
OPEL	Combo (E)	18>	9,0		7,1		5,0
PEUGEOT	Partner	08>	7,6	5,1	4,1		
RENAULT	Kangoo Express (Mk1)	98>07	5,4	5,4			
RENAULT	Kangoo Express (Mk2)	08>	3,4	3,4			
VOLKSWAGEN	Caddy (2K) Life	10>15	8,6	6,7	6,7	6,2	
VOLKSWAGEN	Caddy (2K) Panel	10>15	6,7	7,1	7,3		
VOLKSWAGEN	Caddy (2K) Panel	15>	8,8	6,9	6,5		

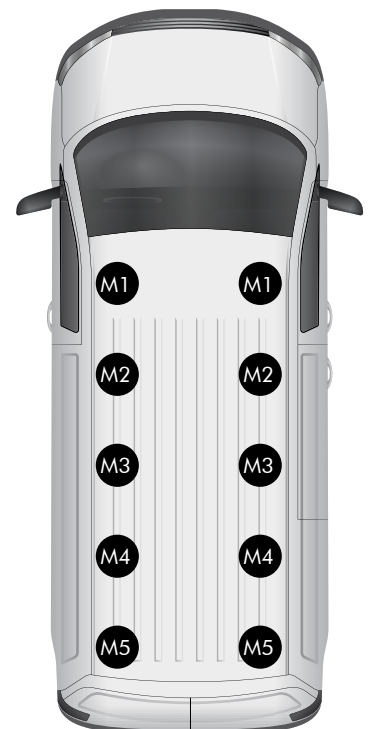

1a

4 x

Klik!

K1 MEDIUM
K1 PRO
K1 PRO ALU

1b

4 x

K1
K1 MEDIUM
K1 PRO
K1 PRO ALU

2

4 x

B

3

4 x

4

2 x M1

M1 M1b

→ M1

2 x M2

M2 M2b

← M2

5

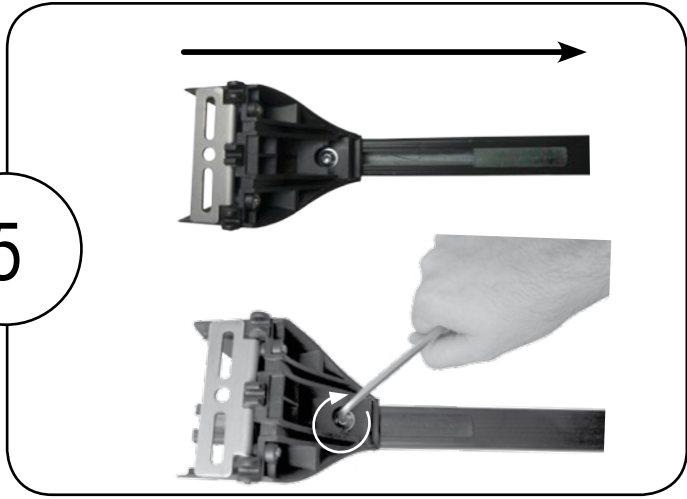

6

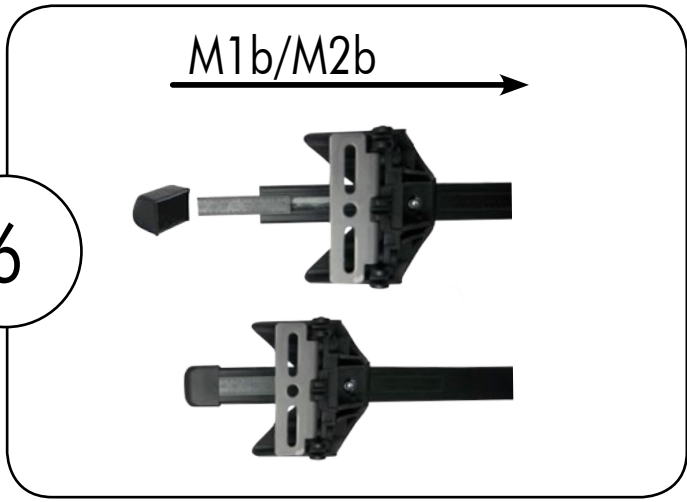

7

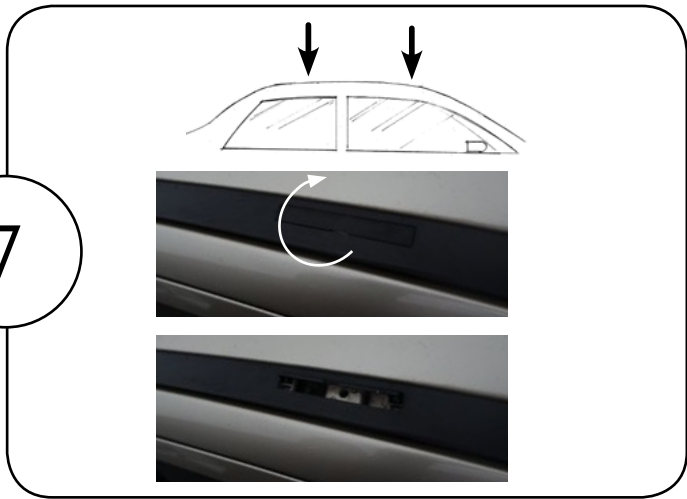

8

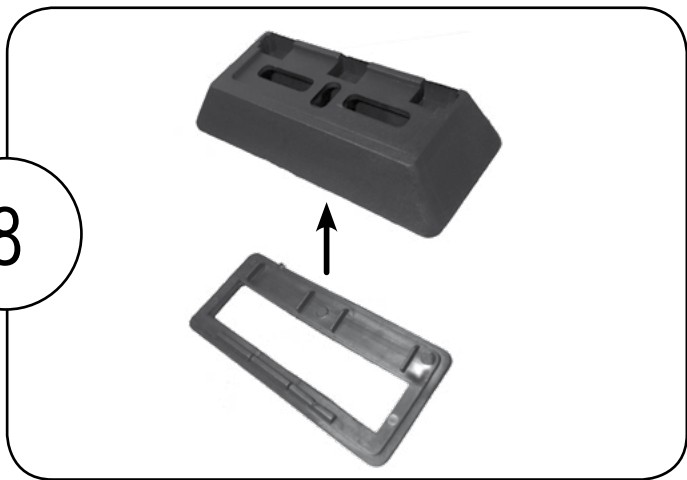

9

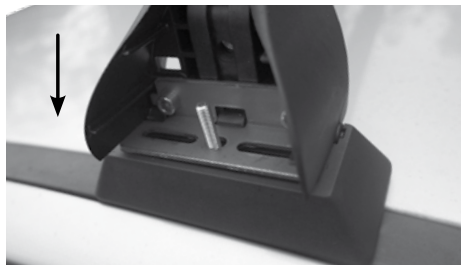
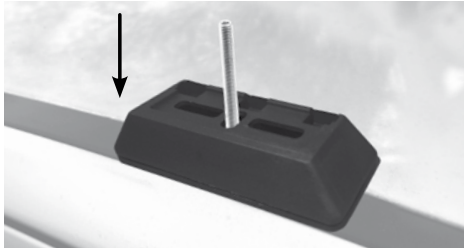
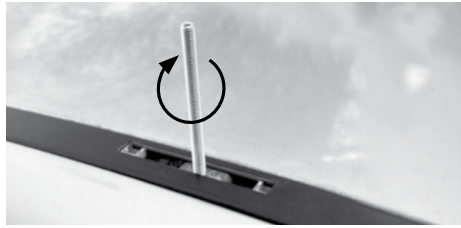

X 4



5 Nm



10

K1



11



K1 MEDIUM
K1 PRO
K1 PRO ALU

MAX
75 kg



NO

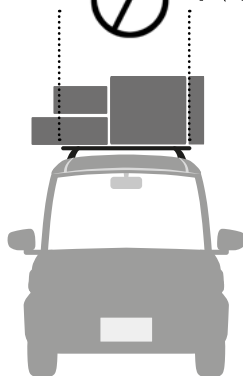

OK

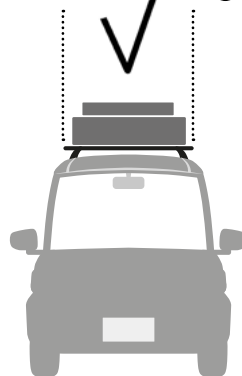

NO

